



PASSION FOR PARTS

ITR BRAND  
**OFF-THE-ROAD TYRES**







## COMPANY PROFILE

ITR, pioneers in parts for tracked equipment, introduces their product line for wheeled equipment to Europe – **Mining, Construction and Industrial Tyres**. Being a renowned Italian based manufacturer of earth moving equipment parts, ITR is now inspired to provide customers with tyres for extreme conditions in order to meet the industries heavy requirements. **Brand loyalty is our strength, customer satisfaction our priority.**



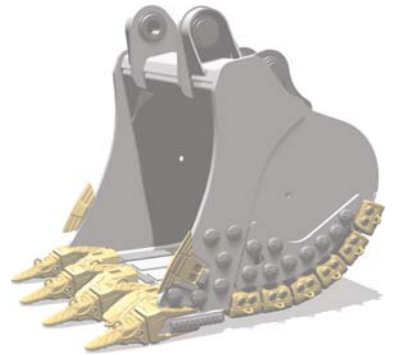
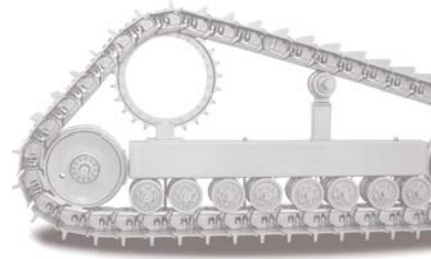

# CONTENTS

## RADIAL RANGE \_\_\_\_\_ 4 - 7

EMR02, EMR04, EMR06, EMR08, EMR09, EMR20



## **ITR RADIAL TYRES**

---

ITR radial tyres are best in class for mining, heavy duty construction and industrial applications. Tyres are manufactured under rigid quality control in highly capable integrated production facilities.

ITR tyre technology ensures premium casing with durable compounds which provide solid traction, long life and excellent resistance to impact punctures. Our professional expertise is dedicated to guide you in choosing the right tyre for the every application with the highest level of customer satisfaction and after sales support.



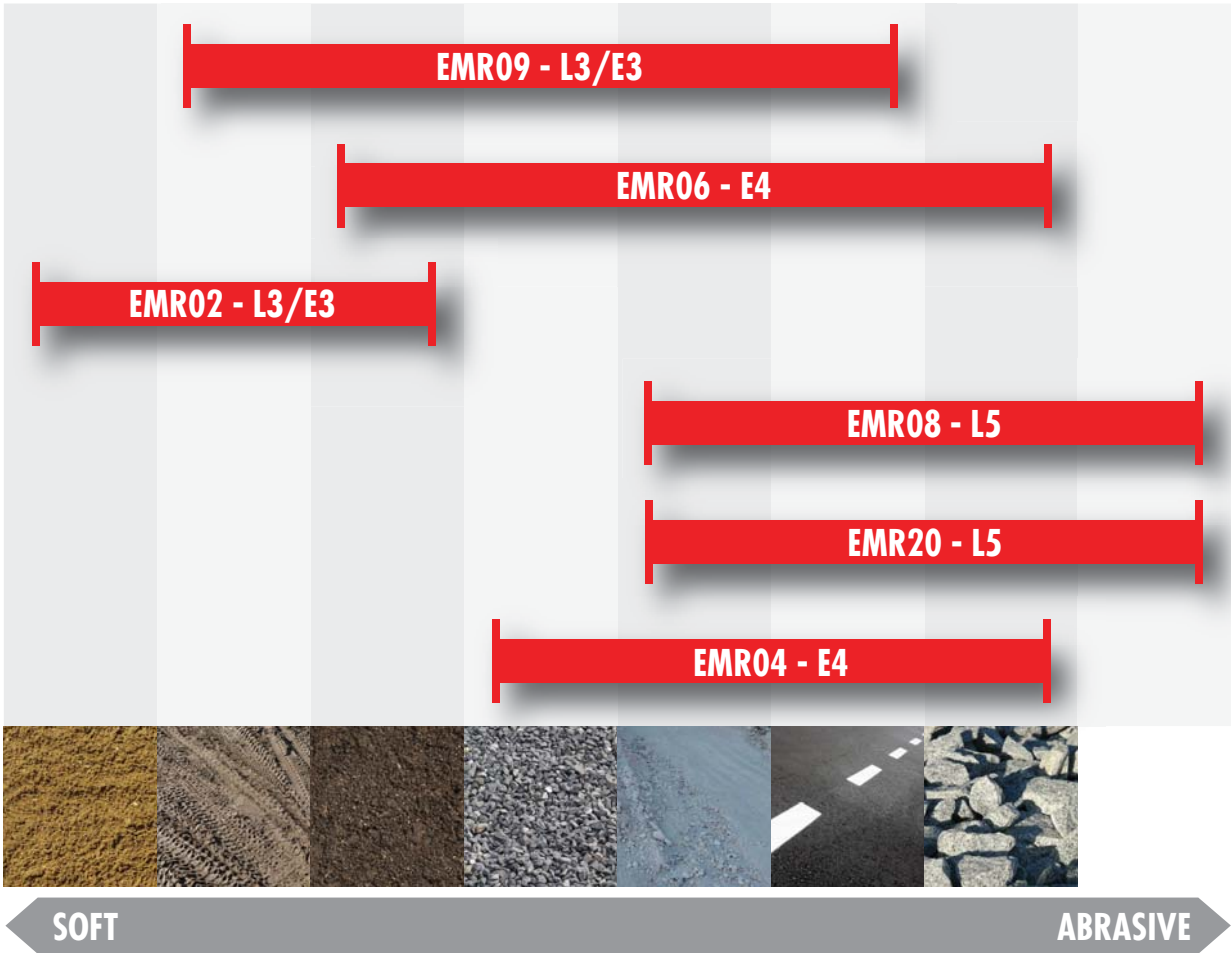

**TYRE MARKING**





**EMR02**



**EMR04**



**EMR06**



**EMR08**



**EMR09**



**EMR20**





## SPECIFICATIONS

Pattern Name	Size	Star Rating	TRA Code	Max. Speed (km/h)	Type	Max. Load (kg)
EMR02	20.5R25	**/*	E3/L3	50/10	TL	7300/9500
	23.5R25	**/*	E3/L3	50/10	TL	9250/12150
	26.5R25	**/*	E3/L3	50/10	TL	11500/15000
	29.5R25	*	L3	10	TL	18000
EMR04	18.00R33	**	E4	50	TL	10900
	21.00R35	**	E4	50	TL	14500
	24.00R35	**	E4	50	TL	18500
EMR06	600/65R25	*	L3	10	TL	9750
	650/65R25	**	E3/L3	50/10	TL	8000/11500
	29.5R25	**	E4	50	TL	14000
EMR08	17.5R25	**	L5	10	TL	8500
	20.5R25	**	L5	10	TL	11500
	23.5R25	**	L5	10	TL	14500
	26.5R25	**	L5	10	TL	18500
	29.5R25	**	L5	10	TL	22400
EMR09	17.5R25	**/*	E3/L3	50/10	TL	5450/7100
	20.5R25	**/*	E3/L3	50/10	TL	7300/9500
	23.5R25	**/*	E3/L3	50/10	TL	9250/12150
	26.5R25	**/*	E3/L3	50/10	TL	11500/15000
	29.5R25	**	L3	10	TL	18000
EMR20	29.5R25	**	E3	50	TL	14000
	35/65R33	**	L5	10	TL	28000
	35/65R33	***	L5	10	TL	32500







a USCO Company

**INTRAMEX Parts GmbH**  
**Heerenholz 22 - 28307 Bremen - Deutschland**  
**Tel. +49 421 485470**  
**info@intramex.de www.intramex.de**